

# COWL TOP INNER SIDE PANEL (ASSY)

## REPLACEMENT

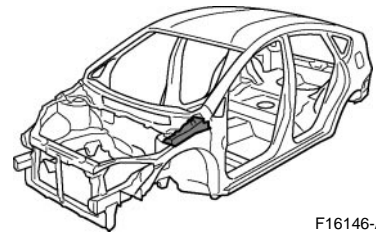

F16146-A

## REMOVAL

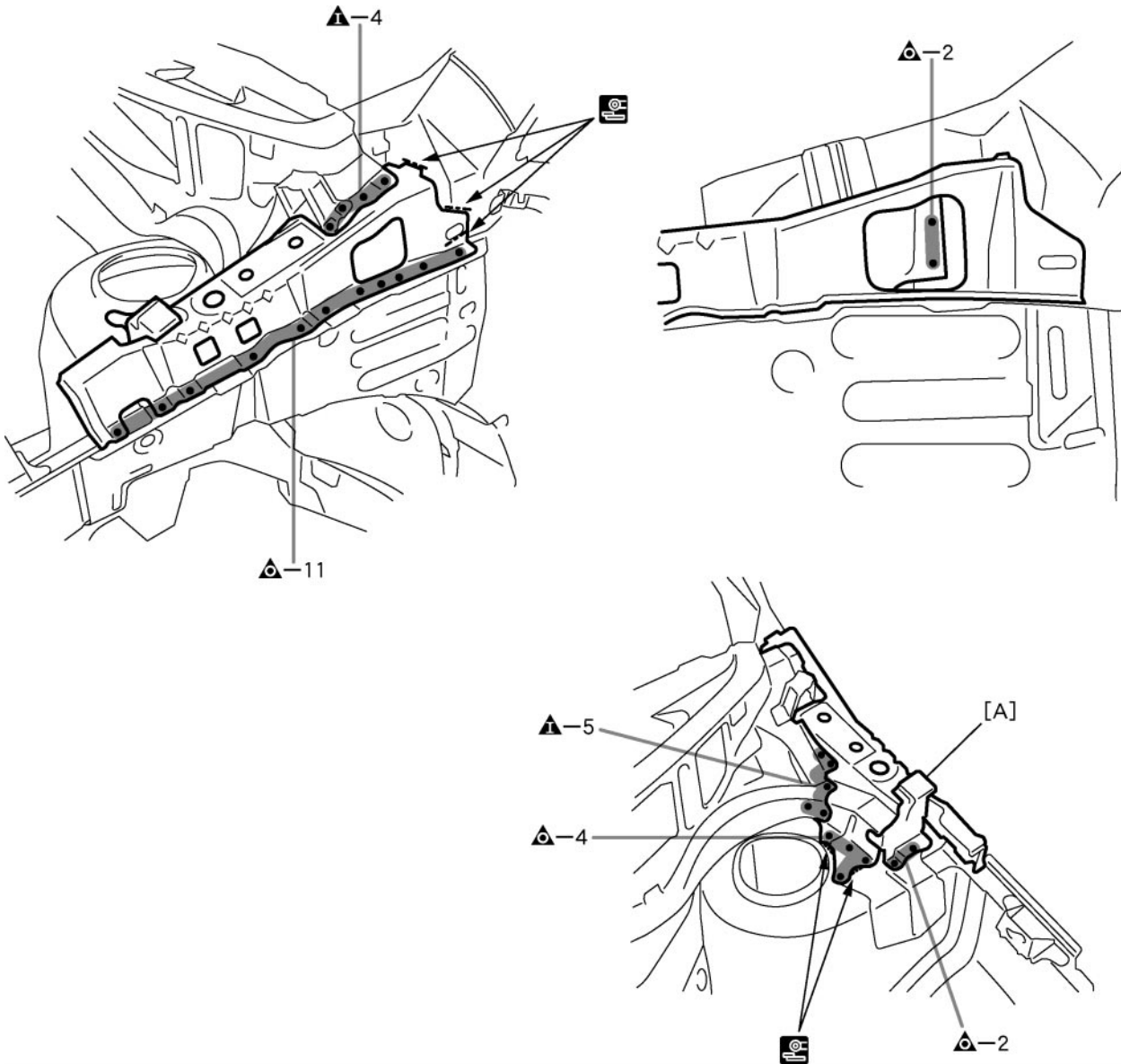

F16146

### POINT

- 1 Remove the [A] the same time.

### PART NAME

[A] Front Apron To Cowl Sidemember Plate

**INSTALLATION**

- Temporarily install the new parts and measure each part of the new parts in accordance with the body dimension diagram. (See the body dimension diagram)
- Inspect the fitting of the related parts around the new parts before welding. This affects the appearance of the finish.
- After welding, apply the polyurethane foam to the corresponding parts.
- After welding, apply body sealer and under-coating to the corresponding parts.
- After applying the top coat layer, apply anti-rust agent to the inside of the necked section structural weld spots.

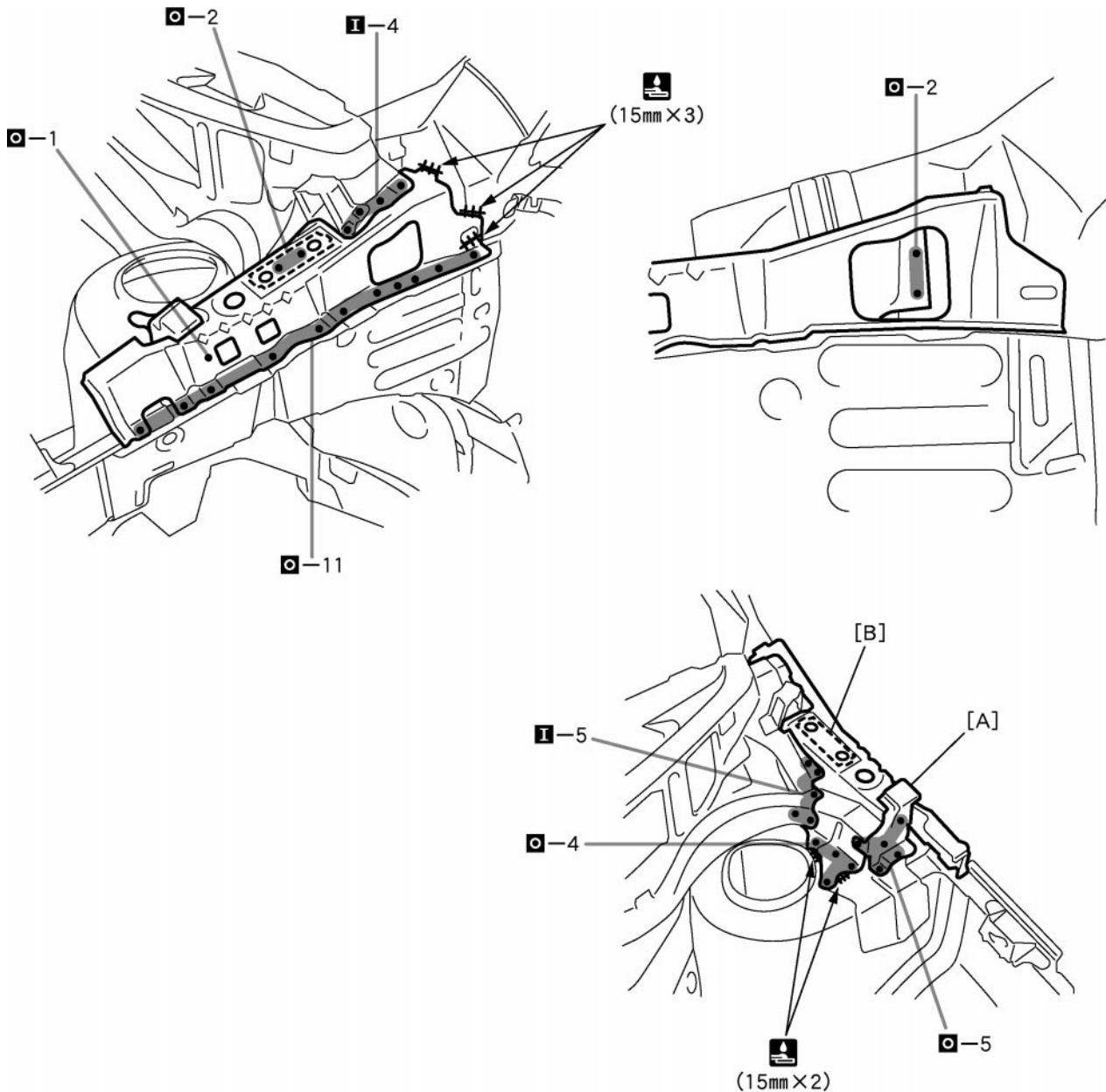

F16147

**POINT**

- 1 Inspect the fitting of the front fender and hood, etc., before welding, since this affects the appearance of the finish.

**PART NAME**

- [A] Front Apron To Cowl Sidemember Plate 15mm (0.59in.) [B] Hood Damper Mounting Bracket